

## Class P, UL Listed Compact LED Driver for Universal Dimming Applications

### Features and Benefits

- High efficiency constant current driver in compact white case reduces shadows in luminaire
- Class 2, UL 8750 listed Class P metal case, IP62 rated
- Dimming < 2% (120VAC only) with triac/incandescent (forward phase) and ELV (reverse phase) dimmers
- Dimming < 5% with 0-10V dimmers
- UNV input 120-277VAC
- Short circuit protection
- Includes mounting tabs for mechanical attachment



**PSSO-1050C-DUALDIM-UNV-P**

### Compatible LED Modules

Nominal DC Output to Module ..... See Table 1

### Ratings and Performance Specifications

Nominal Input Voltage ..... See Table 1  
 Maximum Driver Case Temperature @ designated Tmp ..... +75°C  
 Maximum Operating Range Ambient Temperature (Ta) ..... -30 to +50°C  
 Recommended Screw Installation Torque ..... 75 inch ounces  
 Nominal Power Factor ..... > 0.9  
 Nominal Weight ..... 350 grams  
 Safety/Compliance ..... UL E256805  
 Designed to meet FCC Part 15B and Class A sound rating < 24dBA  
 Designed to comply with IEEE C.62.41-1991, Class A operation

### Application Notes

1. The proper driver case temperature at designated (Tmp) is critical to ensure proper performance and long life. Careful design consideration required for factors such as ambient conditions (for example weather and surrounding atmosphere inside luminaire) and proximity to heat generating components.
2. Abnormal operating conditions such as elevated ambient temperatures can negatively impact output, product lifetime and/or performance.
3. Dims only at 120VAC with most triac and 3-wire ELV dimmers such as Lutron® Diva and Maestro. Complete list of compatible dimmers and application notes available.

## Physical Dimensions

DIMENSIONS  
IN INCHES  
TOLERANCES:  
XX = ± 0.1"  
XXX = ± 0.01"

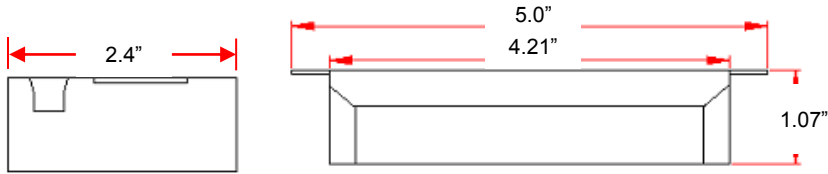

18AWG MIN BLACK (L)  
18AWG MIN WHITE (N)  
15" NOM, 0.25" STRIP/TIN

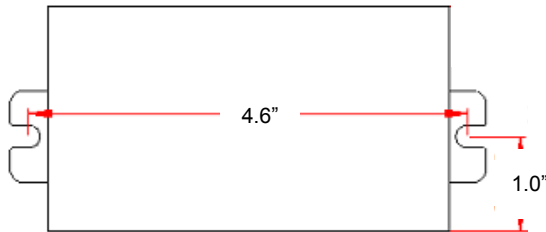

22AWG MIN GRAY (-) DIM  
22AWG MIN PURPLE (+) DIM  
6" NOM, 0.25" STRIP/TIN

22AWG MIN BLACK (-)  
22AWG MIN RED (+)  
9" NOM, 0.25" STRIP/TIN

Table 1, Performance Characteristics at 25°C

Part Number	Dimming				Nominal Output Current (mA DC)	Output Voltage Range (V DC)	Efficiency @ 120VAC, Max Load
	Maximum Output Power (DCW)	Nominal Input Voltage (VAC)	with Triac & ELV Dimmers (VAC)	Dimming with 0-10V Dimmers (VAC)			
PS50-1050C-DUALDIM-UNV-P	50	120-277	120 (only)	120-277	1050	25 - 48	82%

Contact Forlux for complete list of compatible dimmers and application notes

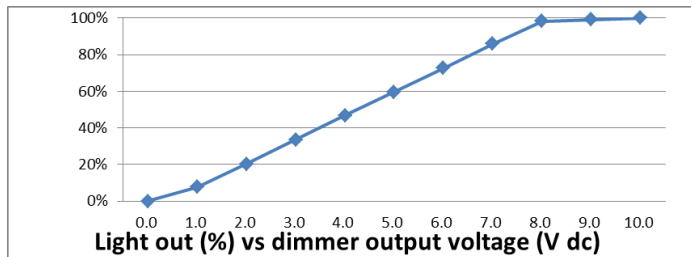

## Packaging

Product is marked with SKU and lot information.  
Sold in groups of (1) unit(s) and packaged with SKU and lot information.

## Warranty

5-Year limited warranty in accordance with published warranty conditions. Product must be used with compatible components (modules, drivers, engines and/or accessories) and no maximum ratings (such as Ts) shall be exceeded during any operating conditions of the system. If product is used with other manufacturer's product, compatibility must be recognized in writing by Forlux.

Forlux owns the following United States patents of which may be applicable to the design or manufacture of this product: 6712486, 6578986, 6846093, 7114831, 7306353, 7102172, 7108396, 7329024, 7387406, 7582911, 7649327, 8926145, 8729810. Additional granted patents, patents pending and other IP protection rights may apply.